

# BLOWER BL1200EU



## Instruction and maintenance manual

Translated from the original Italian version  
Version 04 dated 13/01/2021

### Warning



This instruction manual is integral part of the machine, so keep it with care.

Please read carefully this instruction book before using the blower. An improper use can cause serious or fatal injury.

## INTRODUCTION

We thank you for buying Cifarelli's blower.



The blower that you have bought is a device for cleaning parks, gardens, yards, parking areas, stadiums, sporting structures from leaves, grass, paper and dust.

It is very important to know, observe and apply the safety norms to avoid the risk of serious injury, fatal too, towards himself or third person.

For this reason, it is fundamental that you carefully read and understand the instructions and the warnings of this manual; if you don't understand anything of these instructions, please contact Cifarelli's distributor/seller.

Due to continuous improving which Cifarelli S.p.A. submits its own production, the blower BL1200EU may be subject to changes or modifications without any notice and/or obligation of adaptation of the machines previously sold.

# INDEX

Machine data.....	4
CE conformity certificate .....	5
Symbols .....	6
Safety Norms .....	7
Personal protections .....	7
Prohibitions .....	8
Fuelling .....	8
Safety checking of the machine .....	9
Warning .....	9
Packing .....	11
Standard supplies .....	12
description of the parts of the machine .....	12
Assembly.....	13
Parts of the machine .....	13
Adjusting of the handle .....	15
Adjusting of the shoulder straps and their rapid release .....	16
Fueling operation .....	17
Preparation of the Fuel .....	17
Fuelling .....	18
Blower controls .....	19
Handle.....	19
Using the blower .....	19
Before to start .....	19
Starting.....	20
Suggestions of use .....	22
Stopping the engine .....	22
Engine in running-in period.....	23
Transport.....	23
After using.....	23
Storage norms .....	24
Check-up and maintenance .....	25
Table for Maintenance and Inspections.....	25
Emissions compliance .....	26
Muffler .....	26
Carburettor.....	26
Air filter .....	27
Fuel filter .....	27
Spark plug.....	28
Fan protection .....	28
Cylinder fins .....	28
Trouble shooting .....	29
Discarding and Disposal .....	30
Optionals .....	31
Technical data.....	32



Please note: the packing of the machine has been equipped with some labels containing the model and the serial number of the machine itself; these labels can be taken off and stuck on the pages containing the machine's data and the CE certificate.

## MACHINE DATA

Model code

Serial number engine

Serial number body (if any) \_\_\_\_\_

For any communication or spare parts order it is better to give serial N° of the machine.

Bought from \_\_\_\_\_

Address \_\_\_\_\_

Telephone \_\_\_\_\_

Bought date \_\_\_\_\_

## OWNER'S DATA

Name of the owner \_\_\_\_\_

Address \_\_\_\_\_

\_\_\_\_\_

\_\_\_\_\_

Telephone \_\_\_\_\_



## CE CONFORMITY CERTIFICATE

(ACCORDING TO MACHINERY DIRECTIVE 2006/42/CE)

Manufacturer: **CIFARELLI S.P.A.**, Strada Oriolo 180 - 27058 Voghera - Italia.

Name and address of the person authorized to compile the technical file:  
Roberto Cifarelli, Strada Oriolo 180 - 27058 Voghera – Italia

Herewith we declare under our responsibility, that the machine BLOWER  
SERIE BL1200EU, blower for leaves

Model  
Serial Number

is in conformity with the provisions of safety and health requirements of  
the directive 2006/42/CE;

is in conformity with the provisions of the directive 2014/30/UE;

is in conformity with the regulations:

(UE)2016/1628-(EU)2017/654-(EU)2017/656;

is in conformity with the provisions of the directive:

2000/14/CE (D.Lgs 262/02).

Air volume 0.453 m<sup>3</sup>/s

Measured sound power level 110 l<sub>wa</sub>

Guaranteed combined sound power level 112,5 l<sub>wa</sub>

Procedure executed following enclosed 5.

And furthermore, we declare that the following European harmonized  
standard has been used:

UNI EN 15503:2014; UNI EN ISO 4254-1:2015;

and the following technical specifications have been used:

ISO 11684:1995; EN ISO 14982:2009; EN ISO 20643:2012.







A handwritten signature in black ink, appearing to read 'Raffaele', is written over a large, stylized, horizontal oval scribble.

Voghera 13/01/2021

Raffaele Cifarelli  
President

# SYMBOLS

Here as follows you can find the description of the pictograms used in this manual; some of them are also present on the machine.

	CAUTION! GENERAL WARNING		WORK CLOTHES MUST BE WORN
	READ OPERATOR'S MANUAL		RESPIRATORY PROTECTION MUST BE WORN
	STAY CLEAR OF MACHINE		EYE PROTECTION MUST BE WORN
	CAUTION! THROWN OR FLYING OBJECTS		HEARING PROTECTION MUST BE WORN
	CAUTION! TOXIC RISK		HAND PROTECTION (GLOVES) MUST BE WORN
	CAUTION! HOT SURFACES, RISK OF BURNS		FOOT PROTECTION MUST BE WORN (BOOTS)
	CAUTION! FLAMMABLE MATERIAL		GENERIC PROHIBITION
	CAUTION! TOXIC SUBSTANCES		CAUTION NO FIRE OR SPARK
	CAUTION! ELECTRIC SHOCK HAZARD		CAUTION NO SMOKING
			WARNING: USE IS STRICTLY FORBIDDEN TO PACEMAKER CARRIERS OR OTHER ELECTRICAL / ELECTRONIC MEDICAL DEVICES.

## SAFETY NORMS



This symbol indicates very important instructions contained in this manual. Therefore, please take particular care to the paragraphs marked with this symbol.



### WARNING

Before starting to work it is very important to carefully read and follow all the safety norms described in this chapter. The no-application of these norms can cause serious physical damages.



### WARNING

Before using this machine, contact your doctor to check for any diseases that may prevent you from using this device.



### WARNING

If the serial number on the label or the ones relative to the safety norms come off or it becomes difficult to read them, please ask for them to our head office free of charge (mentioning model and serial number) in order to place them again.

**OTHERWISE, THE MANUFACTURER REFUSES ALL RESPONSIBILITY.**

## PERSONAL PROTECTIONS



It is advised to wear working clothes while using this machine.



In dusty places always wear a suitable mask for the protection of the respiratory system.

Working in places with presence of organic dust such as mould or pollen, can cause allergic or asthmatic reaction to susceptible persons. Please contact a doctor in case of allergic reaction and/or of respiratory difficulty.



To reduce the risk of injury to the eyes, please wear safety glasses with lateral protections.



In case of continuous using, the user can exceed the daily personal exposure level of 80 dB(a).

Therefore, an efficacious personal hearing protection, as the anti-noise headphones, must be worn, in compliance with art 46 DL 277. Anyway, it is advised to undergo to a periodic hearing check-up.



It is advised to wear steel toe boots with no-slip soles.



Never wear large clothes, short trousers, sandals, necklaces, bracelets or similar. Keep hair properly fastened if its length is over the shoulders.

## PROHIBITIONS



### WARNING

The use of this machine is **strictly forbidden** for people with pacemakers or other electrical / electronic medical devices.



Don't smoke, don't eat, don't drink while using the machine.



- It is forbidden the use of this machine to the minors.
- Never start the engine indoors: exhaust gas may kill.
- Don't climb ladders or trees with the machine on the shoulders.
- Never work with this machine if you are tired, sick or under effect of alcohol, drugs or medicines: the user has to be in perfect physical conditions.
- Never use the machine if it is partially assembled but only completely assembled; all the protections (of the engine etc.) must be always entire, at their place, in the same position as indicated in this manual. Replace all parts eventually damaged.
- In case of not authorized alterations on the machine the user will be the only responsible of any possible accident.
- Never leave unattended the machine when it is running.
- It is forbidden the use of the machine with an insufficient lighting level.
- During the use never direct the air flow coming out from the pipe against people or animals.

## FUELLING



Never fuel when the engine is running or when the machine is on the shoulder of the operator.



Remember that fuel is highly inflammable and produces toxic fumes. Mix and pour fuel only outdoors (poisoning or choking risk) and where there are no flames, sparks, fires or similar. Always remove fuel tank cap slowly.



Don't smoke while preparing mixture or re-fuelling.



- Any fuel reserve has to be stocked and transported in suitable homologated tanks, far from children and from heat, following the relative rules.
- Check any possible fuel leakage; always wipe off any possible fuel leakage. Change immediately your clothes if impregnated with fuel.



Before starting the engine, keep yourselves at a distance of at least 3 meters from fuelling site.

## SAFETY CHECKING OF THE MACHINE



For your safety, please check periodically the consumption and the integrity of the following spare parts:

Code	Description	Code	Description
0G.239.00	Elbow	0G.406.00	Mixture cap
0G.293.02	Fan cover	0G.407.00	Mixture tank
21.136.02	Fan	30.053.01	Ground cable
21.138.03	Frame	12.050.01	Engine cover
24.144.00	Shoulder straps	12.047.01	Silent-blocks
0G.290.04	Control handle		

## WARNING

### BEFORE STARTING:



- Start the engine only following the procedure indicated on this manual. Please follow the instructions of use here pointed out.
- Adjust the shoulder straps according to the user's height in order to get the machine close-fitted on both back and shoulders.
- Check the existing of local norms regarding, above all, using hours and noise levels concerning this product and comply with them.
- Be sure that near you a first aid kit will be available as foreseen by the DIN 13164 norm. Replace immediately any medicine used. Make sure to always have at your disposal a tank with at least 15 litres of clean water. In case of helping request to the qualified people, always inform them about: place, description of the happening, number of wounded people, kind of wound and name.
- Ensure that all screws are well positioned and tightened. Make sure that the silencer has been correctly assembled and it works well, never use the machine without silencer.
- Check that the four spring silent-blocks (between the frame and the engine) are entire and well tightened.
- Verify that the machine is entire; in case of falling or heavy impact, check eventual damages; in case of doubt, turn off immediately the machine, if it is running and contact a Cifarelli Service Centre.
- Move anyone from working area and keep people at a distance of at least 15 meters (50 feet) from the machine. If anybody comes closer, stop the engine immediately.



The ignition system of the machine generates a very low intensity of electromagnetic field which may interfere with some pacemakers. In case you have a pacemaker, before using this machine, consult your physician and/or the pacemaker manufacturer to reduce eventual risk of serious and/or fatal injury.

## DURING THE USE:



Use this machine only for the uses described in the manual. Remember that the user is responsible towards third person in the working area of this machine.

- Wear the machine with both the shoulder straps on the shoulders.
- Keep yourselves always in upright, firm and balanced position, never plies the back while wearing the machine.
- Never address the throwing pipe against people or animals.
- Always turn off the engine before removing the machine from the shoulders.
- The use of the blower gets tired; tiredness can cause the loss of control of the machine with possible lesions or damages towards himself or third party. If you feel tired, take a break.
- Take care about the presence of eventual obstacles on the ground (branches, roots, rocks, etc.). In particularly pay attention in condition of wet ground or damp (or worse with snow and ice).
- Never walk backward.
- Never use the machine close to the windows.
- In dusty areas it is recommended to slightly dampen the surfaces, it is advisable the use of a nebulizer.
- In the case you have the doubt to work in the zones with presence of asbestos dust or objects that contain it, observe the norms in force about it. Breathing asbestos is dangerous and may cause serious respiratory illnesses.



- A prolonged use of any power tool exposes the user to vibrations that may cause a phenomenon known as Raynaud's syndrome (known as the "white fingers disease") and the carpal tunnel syndrome; the symptoms are cold fingers, prickle and/or numbness to the hand with a reduced ability to feel and regulate the temperature of the limb and it may cause circulation and nerve damage and tissue necrosis.

However, the reasons for a predisposition are unknown but the cold climate, smocking and some illnesses of the circulation of the blood, together with the vibrations, can be factors of development of the diseases as the syndrome of Raynaud and the syndrome of the carpal tunnel.

Although Cifarelli's blower is equipped with an anti-vibration system, for professional users (who uses the machine in a constant and continuous way), it is advisable to:

- Wear gloves.
- Check the anti-vibration system every time the machine is used.
- Grab well the handle but without tighten too much.
- Take breaks frequently.

Even applying the above-mentioned precautions, in some predisposed subjects may occur the symptoms mentioned before; in such case you have to contact a physician.



It is recommended to use the machine with the three throwing pipes assembled (Picture 1 pos.12, pos.13 and pos.14) in order to approach the terminal (Picture 1 pos.15 or pos.16) to the ground and work with the air flow next the ground.



Remove all the objects as stones, piece of broken glass and all that can be thrown during the work.

It is recommended the use of rakes and brooms to loosen debris before to start to use the blower.



- This muffler incorporates a catalytic converter that become very hot during operation and retain heat for a long time after the engine has been stopped. This is the case even with the engine idling.

- To avoid skin burns, never touch the engine for a long time after switching off.



- To avoid the risk of fire and burns, it is necessary to keep the zone around the exhaust clean by removing leaves, sprigs and any possible residues of oil.

- Let the engine cool in a plain place, away from any material that can take fire.

## ABOUT THE BLOWER:



- The spare parts used for repairing must exclusively be "Cifarelli" original parts in order to grant the safety level of the machine.

- Store the blower with empty tank, cold engine and in a way that none part of the machine may injury someone.

- The user can only do the maintenance operations described in this manual; all other operations have to be done by an authorized Cifarelli's assistance centre. All maintenance operations (except the adjusting of the carburettor) have to be executed with the switch (Picture 13 position 2) on "0" position.

- Always wear protective gloves during maintenance operations. Do not carry out maintenance while the engine is hot.

## PACKING

All CIFARELLI machines are packed in carton boxes to avoid any damage during the transport. The carton used is a raw material and it can be re-used or recycled. (recycling of paper).

**Each box has to be properly stamped a symbol for recycling:**

**DON'T WASTE IN THE ENVIRONMENT.**

# STANDARD SUPPLIES



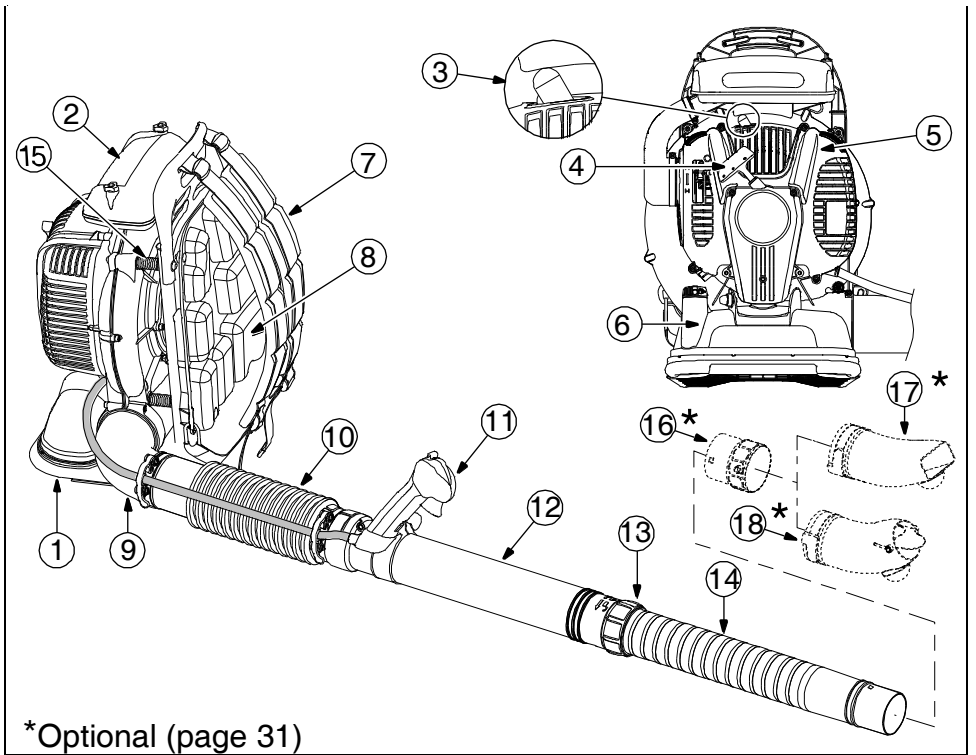

## DESCRIPTION OF THE PARTS OF THE MACHINE



\*Optional (page 31)

Picture 1 - Parts of the blower

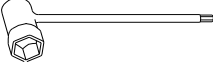
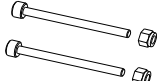
<b>1</b>	Frame	<b>7</b>	Shoulder straps	<b>13</b>	Ferrule for throwing pipe
<b>2</b>	Air filter	<b>8</b>	Cushion	<b>14</b>	Sliding throwing pipe
<b>3</b>	Spark plug cap	<b>9</b>	Elbow	<b>15</b>	Silent-blocks
<b>4</b>	Starter	<b>10</b>	Flexible hose	<b>16</b>	Reduction D.70
<b>5</b>	Cover of the engine	<b>11</b>	Control handle	<b>17</b>	Rectangular curved terminal
<b>6</b>	Fuel tank	<b>12</b>	Swivel throwing pipe	<b>18</b>	Round curved terminal

	Spanners bag		Fuel mixing bottle
	Instruction manual		Spark plug spanner with integrated hexagonal key
	Nr. 2 screws TCEI M5 x 65 Nr. 2 nuts M6 self-locking		Nr.2 Clamps

# ASSEMBLY

## PARTS OF THE MACHINE

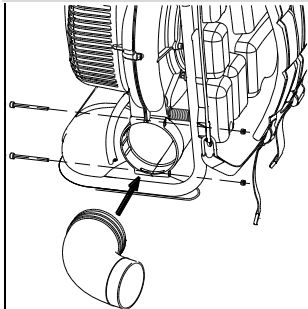

Picture 2 - Assembly elbow

For the assembly of the blower, read the instructions as reported below.

Observing the Picture 2 here on the left:

1. Insert the elbow between the fan cover.
2. Lock the elbow with the two screws and the two nuts by using the hexagonal key integrated in the spark plug spanner (everything is endowed in the spanner bag).

Observing the Picture 3:

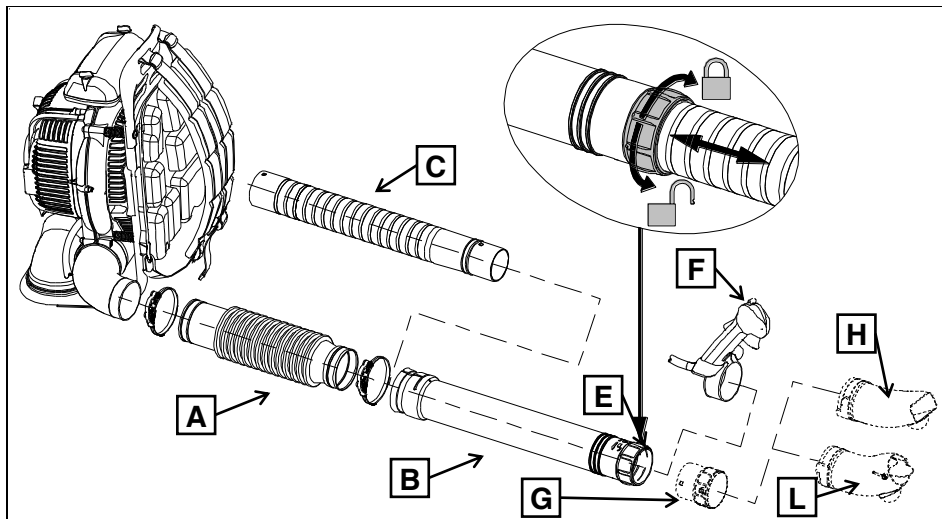

Picture 3 - Assembly of the blower

1. Insert on the elbow the end of the flexible hose **A**.
2. Insert the tube **B** with the expansion cuts on the other end of the flexible hose **A**.
3. Insert the handle **F** on the throwing pipe **B** after having loosened the screw present under the blocking lever (Picture 7) with the hexagonal key endowed with the spanners bag.

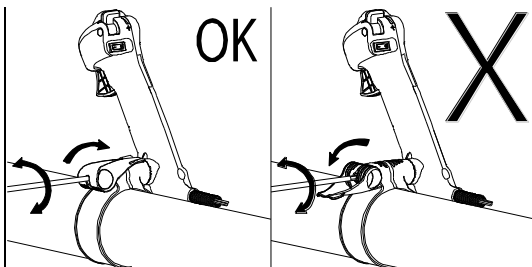

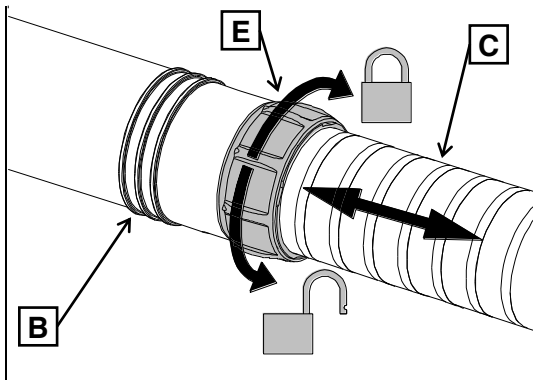

Picture 4 - Assembling of the handle

4. Observing the Picture 4 in the boxes on the right, **with the blocking lever in low position (blocked)**, screw the screw without tightening to the end, but till to lock the handle on the pipe. **NEVER tighten the screw with the blocking lever in open position.**



Picture 5 - Assembling of sliding pipe

5. To extract the extension pipe **C** inside the pipe **B**, turn the ferrule **E** toward , pull the pipe **C**; When you reach the desired position, turn the ferrule **E** toward  to lock the two tubes.
6. In case the optional kit 0G.438.00 (reduction kit D.70 with curved ends) is available, insert the reduction **G** on the telescopic tube **C** and fit one of the two curved terminals (**L** or **H**, Picture 3) on the reduction **G** through the bayonet coupling.

### ASSEMBLY OF THE CLAMPS

To assembly the clamps on the flexible hose (Picture 1 pos. 10) and on the throwing pipe (Picture 1 pos. 12), observe Picture 6 and proceed as follows:

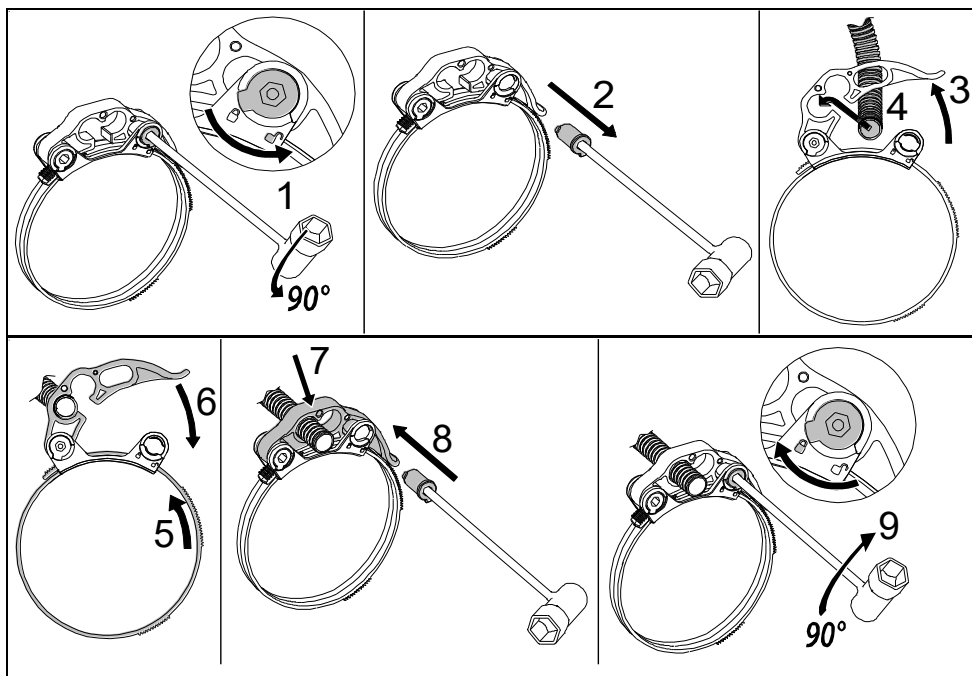

Picture 6 Assembly of the clamps

1. With hexagonal key integrated in the spark plug spanner turn the pin anticlockwise towards the symbol .
2. Remove the pin.
3. Raise the locking lever of the clamp.
4. Insert the black corrugated sheath of the handle into one of the rings.

5. Place the clamp around the flexible pipe, in the end where is connected the pipe **B** (Picture 3) and tighten the clamp by hugging the pipe.
6. Lower the locking lever of the clamp.
7. Keep the clamp locking lever pressed in the position shown in the picture (step 7). The adjusting of the force of rotation of the tube **B** is achieved by tightening more or less the clamp.
8. With the hexagonal key integrated in the spark plug spanner, insert again the pin into the lever (in to the hole from where it was extracted at the step 2).
9. With the hexagonal key integrated in the spark plug spanner, turn clockwise the pin towards the symbol .
10. Repeat the assembly of the second clamp on the other end of the flexible pipe.

## ADJUSTING OF THE HANDLE



### WARNING

The adjusting of the handle has to be done with the engine turned off.

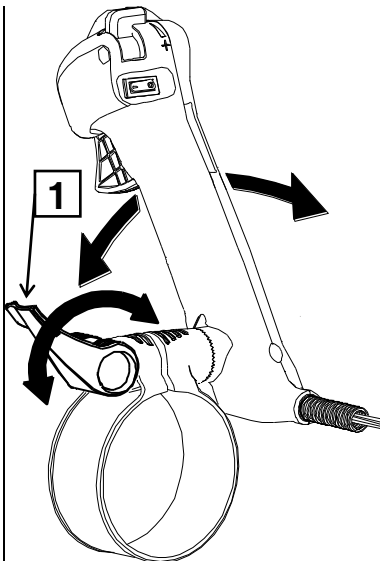

Picture 7 - Adjusting of the handle

The right position of the handle is very important to work comfortably. To adjust the position of the handle, proceed as follow:

1. Raise the blocking lever, Picture 7 pos.1.
2. Find the working position more comfortable, sliding the handle and modifying the inclination too.
3. When you have found the right position, block the handle by lowering the block lever.

## ADJUSTING OF THE SHOULDER STRAPS AND THEIR RAPID RELEASE



### WARNING

The adjusting of the position has to be done with the engine turned off.

Before to use the blower, it is very important to reach the correct weight balance of the machine on your shoulders. This can be obtained by regulating straps length to get the machine close-fitted on both back and shoulders.

We remind you that a well-balanced machine is very important when operating on not smooth grounds.

To tighten the shoulder straps, pull the ribbon as shown in the Picture 9.

To loosen the shoulder straps, lift the buckle as shown in Picture 10.

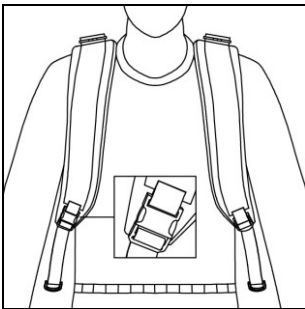

Picture 8 - Position of the shoulder straps

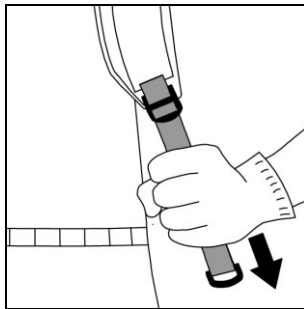

Picture 9 - Tightening the shoulder straps

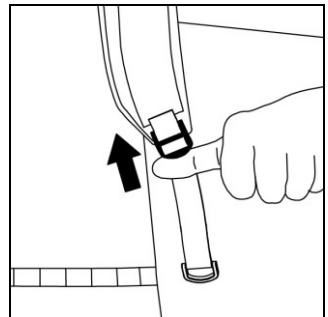

Picture 10 - Loosening the shoulder straps

**In case of emergency, it is possible to remove quickly the blower from the shoulders with the following procedure:**

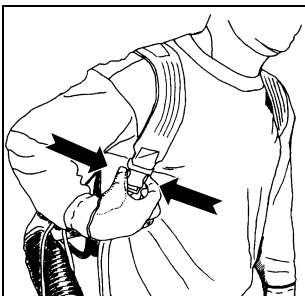

Picture 11 - Quick release

1. With one hand, press the tabs of the quick release placed on the right shoulder strap (shown in square in the Picture 8) as shown in the Picture 11.
2. Accompanied with your bust the movement that will execute the machine, slightly tilting toward left: the blower will fall from your shoulders.

## FUELING OPERATION

This engine can work with a mixture of both leaded or unleaded petrol and oil for two strokes engine but never use petrol mixed with alcohol.

### WARNING



The use of gasoline containing ethanol with a greater rating of 10% can damage the engine.

The use of gasoline with a lower octane rating may increase the temperature of the engine with a consequent risk of piston seizure and damages to the engine.

### WARNING



There are different kinds of oil to be used together with leaded or unleaded petrol. Always use only suitable oil for the petrol with which you prepare the mixture.

Never use automobile engine oil (for 4 strokes engine or diesel) but only use oils suitable for **2 strokes engine (2T)**.

The petrol used has to be “fresh”. After 1 month storage, the petrol is no longer fresh. If you utilize a previous prepared mixture, mix it up again before using.

With leaded petrol use only **mineral** oil with a ratio of 25:1, then mix 25 parts of petrol for each oil part (4%).

With unleaded petrol use only **synthetic** oil, suitable for this kind of petrol, with a ratio of 32:1 (3%) or 50:1 (2%) as specified by the manufacturer of the oil you are using.

### WARNING



The use of unsuitable mixture as, for example, unsuitable oil for two strokes engine, mineral oil used with unleaded petrol or incorrect mixture can invalidate warranty.

## PREPARATION OF THE FUEL



Remember that fuel is highly inflammable and produces toxic fumes. Mix and pour fuel only outdoors (poisoning or choking risk) and where there are no flames, sparks, fires or similar.



Don't smoke during the preparation of the fuel and during the fuelling.



### WARNING

Never prepare the mixture inside the tank of the machine.



The fuel must be prepared and stored in suitable and clean cans, properly closed. The use of plastic cans unsuitable to store fuel may cause engine damage and invalidate the warranty.

## USING THE ENDOWED BOTTLE

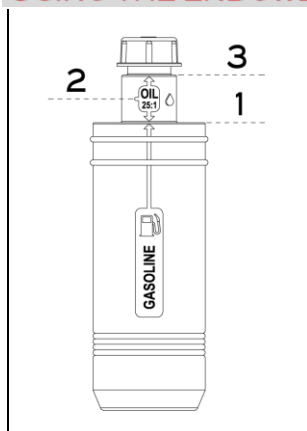

Picture 12 - Fuel mixing bottle

In order to help mixing the fuel, each machine has been supplied with a bottle for mixing fuel in ratios 25:1 (4%) or 50:1 (2%).

Please observe the Picture 12 and proceed as follows to prepare one litre of mixture:

1. Fill the bottle with gasoline till position 1.
2. • To prepare a mixture 50:1 (2%), add oil till position 2.  
• To prepare a mixture 25:1 (4%), add oil till position 3.
3. Screw the cap on the bottle
4. Shake for at least 30 seconds.

The mixture is ready for fuelling.

In case you use a can to prepare the fuel, this has to be properly clean and you should take care to shake the mixture at least for one minute so that the oil can mix itself with the gasoline.

Here as follows the tables with the correct percentages of oil and gasoline.

Table for fuel mixture – MINERAL OIL		
Leaded petrol (Lt)	25:1=4% Oil ( ml )	
2,0	80	
4,0	160	
5,0	200	
8,0	320	
10,0	400	

Table for fuel mixture – SYNTHETIC OIL		
Unleaded Petrol (Lt)	32 :1 = 3% Oil ( ml )	50 :1 = 2% Oil ( ml )
2,0	62.5	40
4,0	125	80
5,0	156	100
8,0	250	160
10,0	312	200

## FUELLING



Never refuel when the engine is running.

To refuel the tank, read the following procedure:

- Put the machine on a clean and smooth surface.
- Unscrew the fuel cap slowly in order to allow to escape gas vapor and fumes from the tank to reduce the risk of fire and/or personal injury.
- Pour slowly the fuel into the tank.
- Close the tank by screwing firmly the cap.
- Wipe immediately off any fuel leakage.

# BLOWER CONTROLS

## HANDLE

Observe the Picture 13 here below to understand how to use the controls of the handle (Picture 1 pos.11) on the throwing pipe:

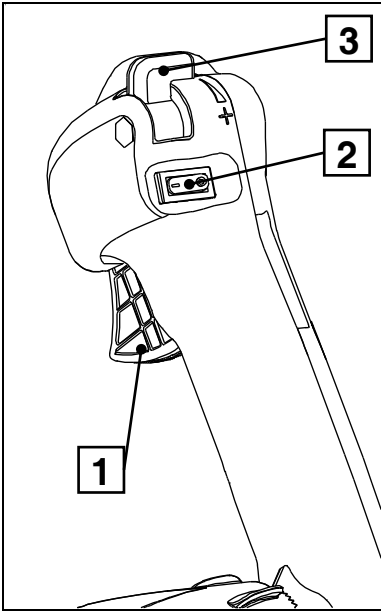

1	Throttle lever
2	Power switch
3	Steady throttle lever

- To accelerate, press the lever **pos.1**.
- To start the engine, the switch **pos.2** has to be positioned on “1”.
- If you want to work with steady RPM, move the steady throttle lever **pos.3** toward the mark “+” to increase the RPM of the engine. To decrease the RPM of the engine, move the steady throttle lever toward the mark “-”.
- To turn off the engine, move the switch **pos.2** to “0”.

Picture 13 - Controls on the handle

# USING THE BLOWER

## BEFORE TO START

Read carefully the chapter “Safety Norms” in case you have not done it yet:

- Place the machine on the ground in a smooth site.
- Verify that the switch (Picture 13 position 2) is not in “0” position (turned off).
- Be sure that no one is close to the machine and/or in front to the throwing pipe.

## STARTING

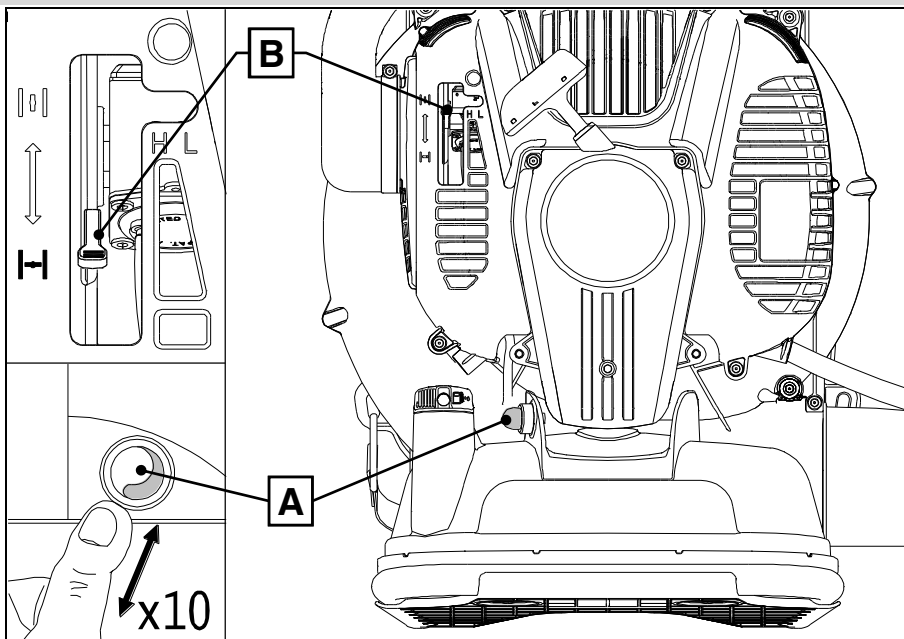

*Picture 14 - Carburettor commands*

The Picture 14 show the bulb **A** and the choke lever **B**, necessary for the starting of the engine.

### STARTING WITH COLD ENGINE (OR TURNED OFF FROM MORE THAN 30 MINUTES)

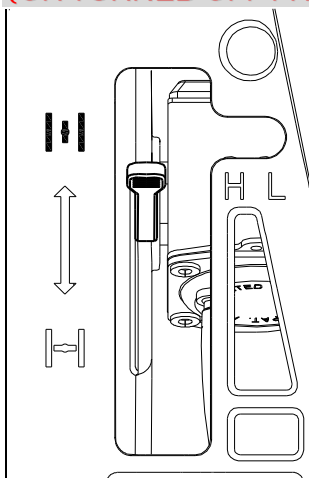

*Picture 15 - Lever position  
with warm engine*

- Press deeply but slowly for 10 times the bulb **A** (Picture 14).
- Put in down position the choke lever **B** till hearing a click (Picture 14).
- Verify that the switch (Picture 13 position 2) is on "1" position (turned on).
- Lay the left hand on the cover of the engine and the left foot on the frame to avoid any movement of the machine.
- With the right hand pull slowly the starting handle (Picture 1 pos.4) until you feel a small resistance; then without leaving the handle, pull with a short and strong hit; by pulling too loosely, you could flood the engine.
- When you hear the first stroke of the engine raise the choke lever **B** in horizontal position (as in the Picture 15) till hearing a click.
- Pull the starting handle one more time to start the engine. Keep the engine at idle speed for at least one minute before accelerating to the maximum power.

## STARTING WITH WARM ENGINE

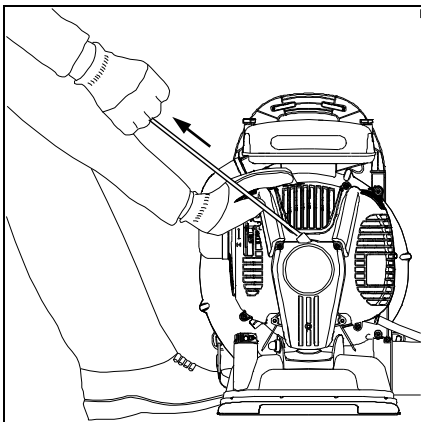

Picture 16 - Starting position

- Press deeply but slowly for 10 times the bulb **A** (Picture 14).
- Raise the choke lever **B** in horizontal position (as in the Picture 15) till hearing a click.
- Verify that the switch (Picture 13 position 2) is on “1” position (turned on).
- Lay the left hand on the cover of the engine and the left foot on the frame to avoid any movement of the machine.
- With the right hand pull slowly the starting handle (Picture 1 pos.4) until you feel a small resistance; then without leaving the handle, pull with a short and strong hit; by pulling too loosely, you could flood the engine.

- Once it is started, keep the engine at idle speed for at least one minute before accelerating to the maximum power.

### WARNING



- Never pull the handle completely till the end because this might damage the spring inside the starter.
- Don't release the handle suddenly but guide it slowly in its seat so the rope wraps up again correctly.

## PROCEDURE FOR FLOODED ENGINE

If the engine floods, please proceed as it follows:

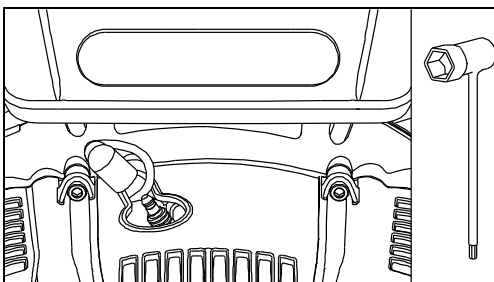

Picture 17 - Position of the spark plug

- Unscrew and remove spark plug, (Picture 1 pos.3 and Picture 17) wipe and dry it.
- Verify that the choke lever **B** is in horizontal position as shown in the Picture 15.
- Pull the starting handle (Picture 1 pos.4) at least 20 times.
- Mount the spark-plug; accelerate to the maximum using the steady throttle lever (Picture 13 pos.3).
- Start the engine.

In case the engine doesn't start, please act as follows:

- Unscrew and remove spark plug, wipe and dry it.
- Turn the engine upside-down in order to have the hole of the spark-plug downwards.
- Pull the starting handle (Picture 1 pos.4) at least 20 times and check if the fuel pours out the spark-plug hole.
- Dry the outside around the centre spark plug.
- Assemble the spark plug; repeat starting procedure keeping the gas lever at maximum position and the choke lever **B** in horizontal position (Picture 15).



**WARNING:** Don't waste the fuel in the environment. If possible, collect it in a suitable container.



When the spark-plug is connected to the cap, it emits high-voltage current, which can be dangerous especially for people with pacemakers or heart diseases.



Several pulls for starting the engine are very tiring. So please rest between several starting pulls.

## HOW TO PUT THE BLOWER ON YOUR SHOULDERS

Wear the blower on your shoulders use the following procedure:

- Lift the blower with the left hand positioning the right shoulder strap on the right shoulder.
- Insert the left arm under the left shoulder strap in order to position it on your shoulder.
- Set the length of the shoulder straps referring to the procedure "Adjusting of the shoulder straps"

## SUGGESTIONS OF USE

Please read carefully the chapter "**Safety precautions**" which will indicate you all the precautions required for blower using.

- Always accelerate by degrees and, before starting the blowing, let the engine to reach the revolutions required.
- While blowing, regulate the engine revolutions depending on your needs; it is not always necessary working at maximum power.
- Utilize the rectangular terminal as "standard"; the round terminal can be used if you find some difficulty to move leaves due, for example, to wet ground.

### WARNING



Pay always attention to any possible objects that can be present in the area you are going to clean (pieces of broken glass, stones....). These objects could be "thrown" by blowing.

## STOPPING THE ENGINE

To switch off the engine:

- Let the engine run at idle speed for at least one minute.
- Move the switch (Picture 13 position 2) to "0".

### WARNING



Always stop the engine and wait till it stops before remove the blower from shoulders.



Remember that the exhaust and engine parts still result hot for a long time after stopping; to avoid the risk of burns, don't touch any part of the engine if it has been just stopped. Before touching them, let these parts be cooler in a plain place, far from any material that could take fire.



## ENGINE IN RUNNING-IN PERIOD

The engine of a new machine should not run immediately at the maximum RPM (full throttle position) until to have consumed the first three tanks of mixture. The components of the engine need a period of settlement during which the frictions are greater. The engine develops its maximum power after about five tanks of fuel.

## TRANSPORT



The transport of the machine in a vehicle must always be executed with empty tank and the machine well fixed to avoid the overturning.

## AFTER USING

To store the blower for a short time:

- Wait the engine become cooler.
- Empty the tank from the mixture.
- Store the machine in a dry place, far from any source of heat.



### **WARNING**

Always store the machine far from sunbeams filtered through windows; this could seriously damage some plastic components.

In case of a long time of inactivity for your blower, read the following chapter “Storage norms”.

## STORAGE NORMS

To store the blower for a long time, proceed as follows:

- Drain all fuel from tank.
- Start the machine at middle power and leave that the engine stops him for lack of fuel.
- Clean with accuracy the tank.
- Clean the blower properly and wipe out all encrustations of dust, grass or other.
- Slightly grease all metal surfaces to prevent corrosion.
- Remove spark plug. Through spark plug hole, pour few drops of oil for two-strokes engine (the same used for the mixture). Pull starter 2 or 3 times. Re-install the spark plug.
- Put the blower and its accessories in a cool and dry place, inaccessible for the children, far from any unprotected heat sources and corrosive chemicals, as for example garden ones.

After a long storage time, before using the blower, all the gaskets and the carburettor have to be checked.

We suggest to perform this check-up by your 'Service Centre'.

Please plan this check-up in advance considering the schedule season of using.

### WARNING



- Remember to store the machine far from sunbeams filtered through windows; this could seriously damage some plastic components.
- Never use fuel mixture stored for more than one month: the engine could be seriously damaged and the warranty would be invalid.

# CHECK-UP AND MAINTENANCE

Your blower needs very few check-up; if regularly done, they will help you to keep it efficient without any problem.

For any maintenance and for buying any spare parts contact your local CIFARELLI ASSISTANCE CENTRE that will give you the necessary support in the best way.

## TABLE FOR MAINTENANCE AND INSPECTIONS

Item	Action	Checking/Maintenance Period					
		Before starting	After using	Each 10 hours	Each 25 hours	Each 50 hours	In case of problem
Complete machine	Inspection	✓					
	Check	✓					
Silent-block	Replacement by the dealer						✓
Nuts and screws	Check	✓	✓				
	Tightening				✓		
Any possible fuel leakage	Check	✓	✓				
Starting rope	Check				✓		
Spark plug	Check				✓		
	Replacement						✓
Air filter	Clean			✓			
	Replacement						✓
Fuel filter	Check by the dealer					✓	
	Replacement by the dealer						✓
Cylinder fins	Check		✓				
Fan cover (for engine cooling)	Clean					✓	
Muffler's inlet and outlet ports, cylinder and piston	Remove carbon encrustation (by the dealer)					✓	

### WARNING



After the first 10 working hours, it is necessary to tighten all nuts and bolts and especially the cylinder, of the carburetor and the exhaust tightening bolts. All the maintenance operations have to be executed with the engine turned off, the machine firmly fixed and the switch (Picture 13 position 2) in position "0".

## EMISSIONS COMPLIANCE

This engine, including the emissions control system, must be operated, used and maintained in accordance with the instructions provided in the user's manual in order to maintain the emissions performance within the legal requirements applicable to non-road mobile machinery.

No deliberate tampering with or misuse of the engine emissions control system has to take place.

Incorrect operation, use or maintenance of the engine or of the non-road mobile machinery could result in possible malfunctions of the emissions control system to a point where the legal requirements applicable are not respected; in such case a prompt action must be taken in order to rectify the system's malfunctions and restore the applicable requirements.

Examples, not exhaustive, of incorrect operation, use or maintenance are:

- Forcing or breaking the devices for metering the fuel;
- Use of fuel and/or engine oil not fulfilling the characteristics shown in the chapter "Preparation of the Fuel";
- Use of not original spare parts, for example spark plug or other.
- Missing or improper maintenance of the exhaust system, spark plug, air filter, including incorrect timing of maintenance.

### WARNING



This muffler incorporates a catalytic converter, needed in order to ensure the engine complies with current emissions standards. Never attempt to modify or remove the catalytic converter: in doing so, you will be breaking the law.

**Tampering with this engine makes the EU emissions certification no more valid.**

## MUFFLER

### WARNING

**If the muffler is damaged, it must be replaced.**

If the muffler frequently becomes blocked, this could be an indication that the efficiency of the catalytic converter is limited.



### WARNING

**Do not operate your machine if the muffler is damaged, missing or modified. Operating the machine with an improperly maintained muffler will increase the risk of fire and hearing loss.**

## CARBURETTOR

The carburetor has a factory setting in accordance with the directives concerning the emissions.

### WARNING

**Do not modify the adjusting of the carburetor by screwing or unscrewing its screws; this operation must be executed in a service centre by qualified staff.**



**A wrong adjusting of the carburetor can cause serious damages to the engine.**

**Furthermore, do not tamper or remove the red caps of protection of the screws of the carburetor.**

In case of problems (engine doesn't idle, irregular RPM or the engine doesn't reach the maximum revolution) contact a service centre.

## AIR FILTER

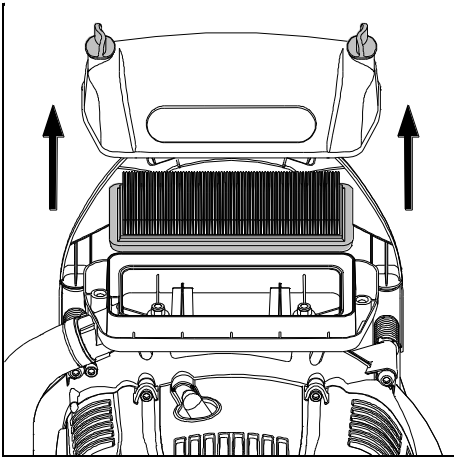

Picture 18 - Air filter

The efficiency of air filter is very important in all engines; it must be often checked and cleaned. To execute this operation, observe the picture on the left and proceed as it follows:

- Unscrew the two knobs to remove the cover and to reach the filter (as shown in the picture on the left).
- Remove the filter and clean it by banging it on a plane surface; then blow it with compressed air **through the holes of the netting and among the fins along length direction**.
- Put the filter back and close the cap by screwing the two knobs.

### WARNING



Use the blower without the filter may damage the engine and invalidate the warranty.

Change the filters when you note that cleaning up is no longer efficient.

## FUEL FILTER

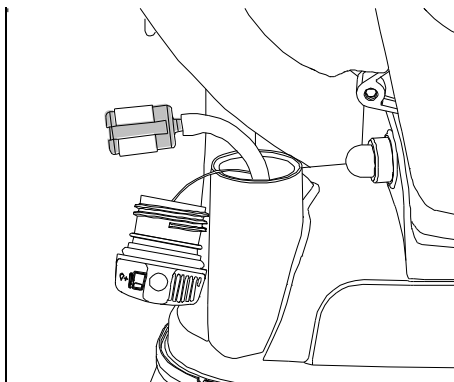

Picture 19 - Fuel filter

We recommend to replace the fuel filter, present inside the tank, at least one time for year. **This operation has to be executed by a Cifarelli's dealer.**

- Empty the fuel tank.
- Extract the filter from the tank and disconnect it from the fuel hose.
- Assembly a new fuel filter into the fuel hose.
- Insert again the filter in the tank.

### WARNING



The missed replacement of a dirty fuel filter compromises the performances of the engine and its functionality.

## SPARK PLUG

The engine operation and starting depends on the spark-plug efficiency. To disassemble the spark plug:

- Disconnect the cap of the spark plug shown in the Picture 1 position 3.
- Unscrew the spark plug with the endowed spanner.

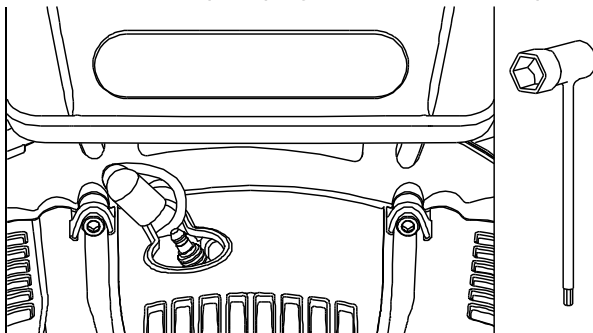

Picture 20 - Spark plug position

Be sure that the spark plug is always well tightened and clean and the gap between electrodes is between 0.5 mm and 0.6 mm (see the distance between the two arrows in the above picture).

When the central electrode is worn up or rounded, replace the spark-plug.

If after few working hours, the carbon incrustation is significant, it means that the quality of the oil used for the fuel mixture is poor or that the proportion fuel/oil is incorrect.

If a bridge between the electrodes forms too often, please clean cylinder head, piston inlet and outlet of exhaust (contact a SEVICE CENTRE).

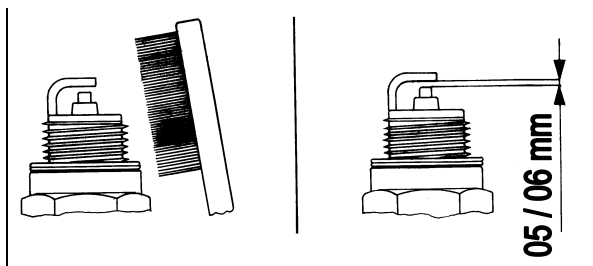

Picture 21 - Spark plug maintenance

### WARNING



It is fundamental to use only and exclusively spark plug of the model reported in the technical data at page 32 of this booklet. The use of not conforming types of spark plug can overheat the engine.

**The use of different spark plug will void the warranty.**



### WARNING

If you disassemble the spark-plug just after switching off the engine, use the gloves! In fact, the spark-plug reaches high temperature and it burns.

## FAN PROTECTION

After a long use of the blower, the protection of the fan (in the back of the cushion) may become very dirty. This can cause a bad air inlet (with less volume) and may be dangerous for the fan as it can break and/or overheating the engine due to dust. So please clean fan protection if it looks dirty; take care to clean the slits of the fan cover too, important for the cooling of the engine.

## CYLINDER FINS

After long use, especially in dusty places, it is necessary to clean the cylinder fins because they may become very dirty. This causes a bad cooling of engine and may be dangerous for causing piston seizure making necessary the replacement of cylinder and piston

# TROUBLE SHOOTING

## The engine doesn't start

	<b>Cause</b>	<b>Solution</b>
1.	The switch (Picture 13 position 2) is on "0".	Move it to "position "1".
2.	Damaged ground cables or lack of contact.	Replace it or insulate it.
3.	Absence of fuel.	Refuel.
4.	Defective valve in the fuel cap.	Clean or replace it.
5.	Clogged tank fuel filter.	Clean or replace it. Contact a 'SERVICE CENTRE'.
6.	Flooded engine.	See the instructions "Procedure for flooded engine" at page 21.
7.	Dirty spark plug.	See chapter "Spark plug" at page 28.
8.	Current doesn't reach the spark plug.	Defective ignition coil or not well regulated or the cable is broken. Contact a 'SERVICE CENTRE'.
9.	Carburettor suction not working.	See points 3, 4, 5. Contact a 'SERVICE CENTRE'.
10.	Dirty carburettor air filter.	See the chapter "Air filter" at page 27.

## The RPM is not regular, engine stops

	<b>Cause</b>	<b>Solution</b>
See points 5, 7, 10		
11.	Spark plug not firmly tightened.	Tighten it using the proper spanner.
12.	Damaged ground cables or lack of contact.	Replace or insulate it.
13.	Defective ignition coil or not well regulated.	Replace it. Contact a 'SERVICE CENTRE'.

## Faulty engine or backfiring

	<b>Cause</b>	<b>Solution</b>
See points 5, 7, 10, 13, 16		
14.	Incorrect thermic degree of spark plug.	Only use the suggested spark-plug. See 'Technical data' at page 32.
15.	There is a "bridge" between the electrodes of the spark plug. Presence of particles of encrustation between the electrodes	Clean or replace the spark plug. If the problem occurs frequently, see the chapter "Spark plug" at page 28. Contact a 'SERVICE CENTRE'.

## Engine doesn't idle

	<b>Cause</b>	<b>Solution</b>
16.	Idle speed to be regulated.	Contact a 'SERVICE CENTRE'.
17.	Air infiltrations through gaskets.	Check screws tightening and gaskets condition.

## Presence of high vibrations during the use

	Cause	Solution
18.	The fan is broken.	Replace it. Contact a 'SERVICE CENTRE'.
19.	The silent blocks are loosened or worn out.	Check the screws of the silent blocks or replace the silent blocks.

## Engine does not reach max. revolution

	Cause	Solution
See points 4, 5, 7, 10, 13		
20.	Exhaust hole clogged by combustion deposits.	Clean or replace it. Contact a 'SERVICE CENTRE'.
21.	Air infiltrations through gaskets.	Check screw tightening and gaskets condition.
22.	Worn oil-proof rings on the crankshaft.	Replace it. Contact a 'SERVICE CENTRE'.
23.	Insufficient compression of the cylinder.	Contact a 'SERVICE CENTRE'.

## DISCARDING AND DISPOSAL

Discarding and disposal are under client's responsibility.

Before discarding the machine, please verify the general conditions of the same, checking that there are no parts that could be broken during the discarding.

Please comply with the laws in force in your Country following environmental protection.



### WARNING

Only qualified people with individual protection devices (safety shoes and gloves), tools and auxiliary means can discard the machine.



### WARNING

The disassembly of the machine for the discarding has to be done with the engine switched-off.





Before discarding the machine, we recommend you to please neutralize all the dangerous parts and then:

- Let discard only by specialized Companies.
- Disassemble the eventual electric device complying with the laws in force.
- Keep separately fuel mixture and chemicals, to be discarded by authorized Companies following the laws of the Country where the machine has been used.

Destroy this instruction manual and the CE mark certificate while discarding the machine.

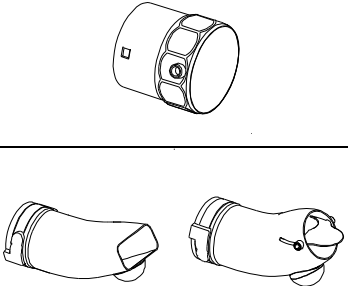
# OPTIONALS

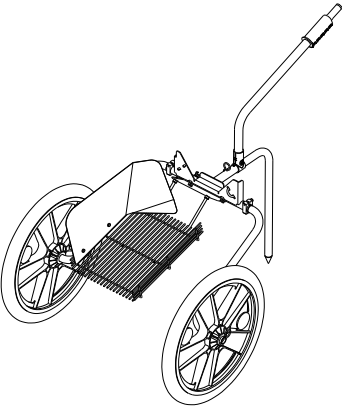
<p>Code 0G.438.00</p>		<p>Reduction kit D.70 with curved terminals. The kit includes the reduction, the rectangular curved terminal and the round curved terminal, suitable for wet soils and wet leaves.</p>
<p>Code 0G.373.00</p>		<p>The blower can be used in apiculture <b>for the removal of the bees</b> during the cleaning of the honeycomb, which precedes the step of the honey extraction. Through the volume of air generated by the blower, the operation is performed <b>quickly and without harming the bees</b>. To facilitate the work and to direct in an optimal way the air on the supers of the hives, it is recommended to install on the machine the appropriate kit composed by a 2 meters long hose and a "duck beak" spreader that widens the air flow produced.</p>
<p>Code 99.310.01</p>		<p>To work in flat or easily accessible areas, you can place the machine on the <b>trolley</b> for V1200 vacuum (Code 99.310.01) by applying the supports for mounting the blower BL1200EU (code 0G.382.00).</p>

## TECHNICAL DATA

Engine	Cifarelli C7 2 strokes, single cylinder, air cooled
Displacement	77 cc
Bore	mm 52
Stroke	mm 36
Maximum power	kW 3,6 (5 HP)
Carburettor	Diaphragm WALBRO
Electric system	Electronic ignition
Spark plug	Champion RCJ6Y
Fuel	Mixture of petrol and oil for two strokes; see chapter 'Preparation of the Fuel' at page 17.
Fuel tank capacity	2,3 litres
Empty weight	Kg. 10,13 (without blowing device) Kg. 11,32 (with blowing device)
Air volume (without blowing device)	1620 m <sup>3</sup> /h (57562 cubic ft)
Air volume (with blowing device)	1092 m <sup>3</sup> /h (38563 cubic ft)
Air speed (with blowing device)	82,3 m/s
Noise (EN 22868)	(EN ISO 11201) Acoustic pressure level L <sub>pa</sub> = dB 101 + 4 (Kpa) (EN ISO 3744) Acoustic power level L <sub>wa</sub> = dB 112,5
Noise (ANSI B175.2)	Acoustic pressure level at 15 meters at maximum RPM L <sub>pa</sub> = 79,4 dB(A) Acoustic pressure level at 15 meters at idle speed L <sub>pa</sub> = 61,3 dB(A)
Vibrations (EN ISO 20643)	Average quadratic value detected at the handle a <sub>wh</sub> < 2,5 m/s <sup>2</sup>
Electromagnetic compatibility (EN ISO 14982)	Conforming - report REI

*Due to the continuous improvement on Cifarelli's products, the above-mentioned features may change without prior notice and/or without any obligation to upgrade previously sold devices.*



180, Strada Oriolo - 27058 Voghera - Italia  
 Tel. +39 0383/3448.1 - Fax +39 0383/344848  
<http://www.cifarelli.it> - Email [info@cifarelli.it](mailto:info@cifarelli.it)